



July 17, 2024 YMS Release Notes - PDF Version

Publication date July 10, 2024

Table of Contents

- 1. July 17, 2024 Release Notes 3
 - 1.1. Feature Updates 3
 - 1.1.1. Check In at a Driver Kiosk with Non-shipment Number Identifiers 3
 - 1.1.2. Configure Safety Notice Settings for the Driver Kiosk 3
 - 1.1.3. Updated List Count on the Trailer Listing Page 3
 - 1.1.4. Update Trailer Information from the Wave Loading Page 4
 - 1.1.5. Add Facility Map to Gate Passes 4
 - 1.1.6. Auto Spot is Now Supported for Live Loads 5

1. July 17, 2024 Release Notes

1.1. Feature Updates

1.1.1. Check In at a Driver Kiosk with Non-shipment Number Identifiers

Users Impacted: All Users

Update Summary: Users can now configure a shipment's Reference 2 # to contain up to five (5) comma-separated, non-shipment identifiers. These identifiers are searchable at the Driver Kiosk. Inform OTR drivers they can use these non-shipment identifiers when checking in.

1.1.2. Configure Safety Notice Settings for the Driver Kiosk

Users Impacted: Administrators

Update Summary: Administrator users can configure Safety Notice rules to appear in the Driver Kiosk when a driver checks in to a site. Up to 20 rules can be created for a Safety Notice. Each notice can have up to 200 characters.

Supporting Documentation:

- [Configure Safety Notice Settings for Check-in with the Driver Kiosk](#)

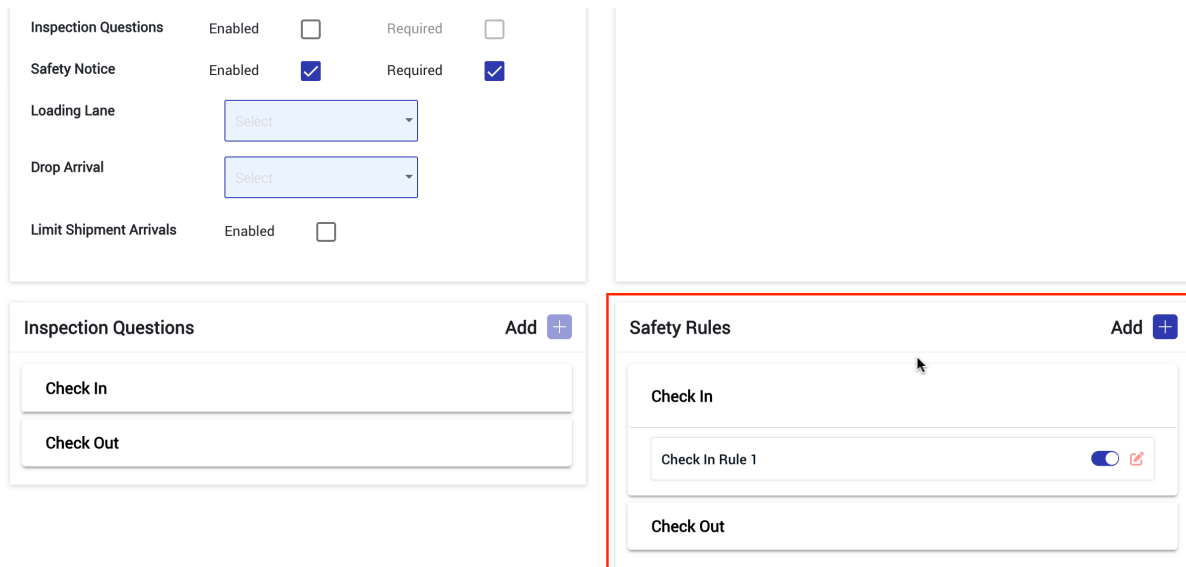

1.1.3. Updated List Count on the Trailer Listing Page

Users Impacted: All users

Update Summary: The Trailer Listing page now shows the trailer count as 10000+ if there are more than 10,000 trailers associated with the account.

Supporting Documentation:

- [Trailer Listing](#)

1.1.4. Update Trailer Information from the Wave Loading Page

Users Impacted: All Users

Update Summary: Users can update the trailer number for a shipment from the Wave Loading page.

Supporting Documentation:

- [Wave Loading](#)
- [Update the Trailer Number for a Shipment from Wave Loading](#)

The screenshot shows a web form titled "Edit Wave - Shipment" with a close button (X) in the top right corner. The form contains four main input fields:

- Shipment***: A text input field containing the value "094446018914_1".
- Filter***: A dropdown menu with the text "Select Filter" and a downward arrow.
- Dock Door***: A dropdown menu with the value "P2-CD-01" and a downward arrow.
- Trailer***: A dropdown menu with the text "Select Trailer" and a downward arrow. This dropdown is open, showing a search bar with the word "SEARCH" and a magnifying glass icon. Below the search bar is a list of trailer numbers: T400444, T565748, T739930, T925232, and T943094. A vertical scrollbar is visible on the right side of the list.

1.1.5. Add Facility Map to Gate Passes

Users Impacted: All Users

Update Summary: The Gate Pass can now be configured to include a map of the facility. Gate Passes can be printed from the Gate Console Arrivals table.

Supporting Documentation:

- [Print a Gate Pass](#)
- [About Gate Configuration](#)

1.1.6. Auto Spot is Now Supported for Live Loads

Users Impacted: All Users

Update Summary: Live loads can be assigned spot tasks through task automation.

Supporting Documentation:

- [Configure Task Settings for Automated Task Assignments](#)

The screenshot displays the YMS interface for task management. On the left, the 'Trailer List' table shows two trailers with their respective statuses and load types. The 'LIVE' status for the first trailer is highlighted. On the right, the task configuration panel for 'VIEW 5711 - SPOT' shows various settings, including a 'Task Automation' button highlighted in a red box. The task configuration also includes a progress bar, dock door information, task type, priority, hold status, and creation time.

Trailer	Carrier ID	Type	Status	Commodity	Load Type	Delivery / Pickup	Location	Zone
TRMX...	AACT	TRAILER 53	EMPTY 17H 20M		LIVE		SITE 1 ARRIVAL 17H 20M	MAIN_GATE
TRMX...	AACT	TRAILER 53	EMPTY 17H 19M		DROP		SITE 1 ARRIVAL 17H 19M	MAIN_GATE

Task Configuration Details:

- Task ID: VIEW 5711 - SPOT
- Task Type: SPOT
- Priority: Normal (High toggle)
- Hold: No (Yes toggle)
- Created Time: JUN 27, 2024 06:19:07
- Created By: Task Automation
- Assigned To: +

Trailer List Summary:

TRAILERS	FROM LOCATION	CURRENT STATUS
TRMXDRL001 AACT	ARRIVAL	EMPTY